

Phonak Naída™ B-R RIC

(B90/B70/B50)

User Guide



A Sonova brand

PHONAK
life is on

This user guide is valid for:

Wireless hearing aid



Phonak Naída B90-R RIC	2017
Phonak Naída B70-R RIC	2017
Phonak Naída B50-R RIC	2017

Non wireless charging accessories



Phonak Charger Case RIC	2016
Phonak Power Pack	2016
Phonak Mini Charger RIC	2016



Your hearing aid & charger details

- ❶ If no box is checked and you do not know the model of your hearing aid or charging accessories, please ask your hearing care professional.
- ❶ Naída B-R RIC contains a built-in and non-removable rechargeable lithium-ion battery.
- ❶ Please also read safety information regarding handling rechargeable hearing aids (chapter 21).
- ❶ Please ensure to charge and use the hearing aid within operating temperature range: +5° to +40° Celsius (41° to 104° Fahrenheit)

Hearing aid model

- ☐ Naída B90-R RIC
- ☐ Naída B70-R RIC
- ☐ Naída B50-R RIC

Earpieces

- ☐ Dome
- ☐ SlimTip
- ☐ cShell

Charging accessories

- ☐ Charger Case RIC incl. power supply
- ☐ Power Pack
- ☐ Mini Charger RIC incl. power supply

Your hearing aids and chargers have been developed by Phonak – the world leader in hearing solutions based in Zurich, Switzerland.

These premium products are the result of decades of research and expertise and are designed to keep you connected to the beauty of sound! We thank you for making such a great choice and wish you many years of listening pleasure.

Please read the user guide carefully to make sure that you understand and get the best out of your hearing aids. For more information about features and benefits, simply contact your hearing care professional.

Phonak – life is on
www.phonak-us.com

Contents

Your hearing aid and charger

- | | |
|---------------------------------------|----|
| 1. Quick guide | 8 |
| 2. Parts of the hearing aid & charger | 10 |

Using the charger

- | | |
|------------------------------|----|
| 3. Preparing the charger | 14 |
| 4. Charging the hearing aids | 15 |

Using the hearing aid

- | | |
|--------------------------------------|----|
| 5. Left & right hearing aid markings | 22 |
| 6. Push button | 23 |
| 7. On/Off | 24 |
| 8. Putting on the hearing aid | 25 |
| 9. Removing the hearing aid | 26 |

Further information

- | | |
|---|----|
| 10. Operating conditions | 27 |
| 11. Care and maintenance | 28 |
| 12. Exchanging the earwax protection | 30 |
| 13. Roger for conversation in noise and over distance | 35 |
| 14. Wireless accessories | 37 |
| 15. Join your hearing loss community! | 38 |
| 16. A solution beyond your hearing aid | 39 |
| 17. Service and warranty | 42 |

18.	Compliance information	44
19.	Information and description of symbols	49
20.	Troubleshooting	54
21.	Important safety information	58

1. Quick guide

Charging your hearing aids

After placing your hearing aid in the charger, the indicator light will slowly blink until the hearing aid is fully charged. When fully charged the indicator light will be constantly on, i.e. solid green light.

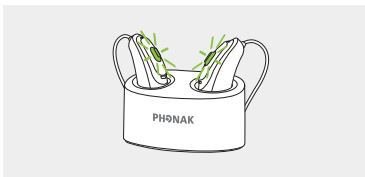
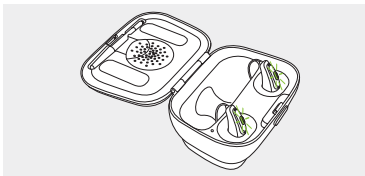

Left & right hearing aid markings

Blue marking for
left hearing aid.

Red marking for
right hearing aid.

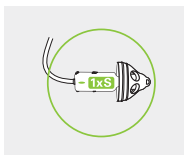
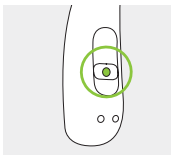

Push button with indicator light

The push button has two functions:

A short push can have various functions. The function for your hearing aid is indicated in your individual instructions.

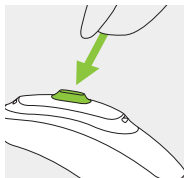

A long push (3 seconds) is used to switch the hearing aid on/off.

On/Off

Firmly press the button using the tip of your finger for 3 seconds until the indicator light blinks.

On: One short blink

Off: Two short blinks

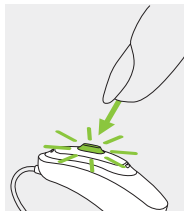

i Before using Naída B-R RIC for the first time, it is recommended to charge it for 3 hours.

2. Parts of the hearing aid & charger

The following pictures show the hearing aid model and charger accessories described in this user guide. You can identify your personal models by:

- Checking "Your hearing aid & charger details" on page 3.
- Or comparing your hearing aid and charger with the following shown models.

Possible earpieces



Dome



SlimTip



cShell

Naída B-R RIC

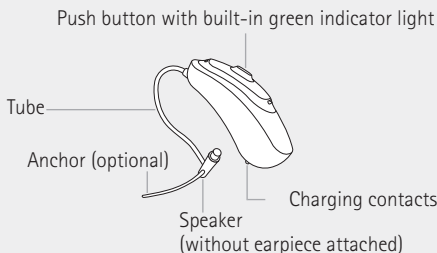

Charger Case RIC

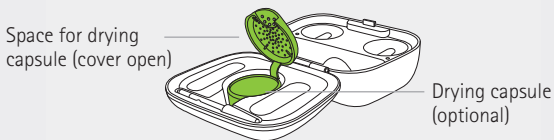

Charger Case RIC with optional Power Pack

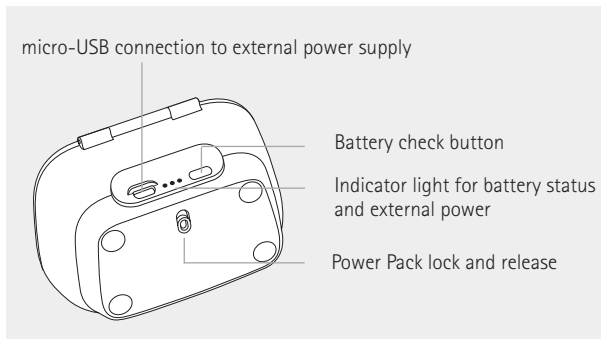
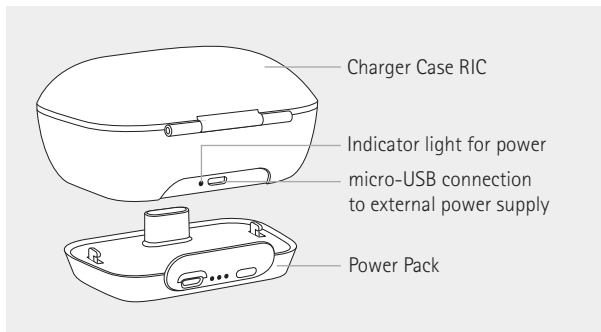

Mini Charger RIC



Hearing aid charging inserts
with left/right indicators

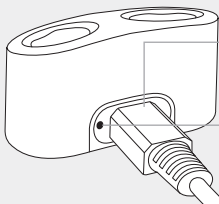

micro-USB connection
to external power supply

Indicator light for power

3. Preparing the charger

Connecting the power supply

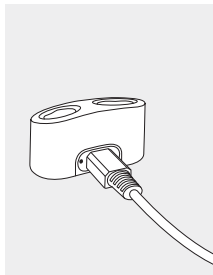
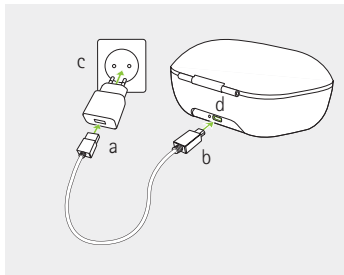

- a) Plug the larger end of the charging cable into the power supply.
- b) Plug the smaller end into the micro-USB port on the charger.
- c) Plug the power supply into a power outlet.
- d) The indicator light is green when the charger is connected to the power supply.

4. Charging the hearing aids

- ① Low power: You will hear two beeps when the battery is low. You will have approximately 60 minutes before you have to charge the hearing aids (this can vary, depending on the hearing aid settings).

- ① Naída B-R RIC contains a built-in and non-removable rechargeable lithium-ion battery.
- ① Before using Naída B-R RIC for the first time, it is recommended to charge it for 3 hours.
- ① The hearing aid must be dry before charging, see chapter 11.
- ① Please ensure to charge and use the hearing aid within operating temperature range: +5° to +40° Celsius (41° to 104° Fahrenheit).

4.1 Using the Charger Case RIC or Mini Charger RIC

Please refer to chapter 3 for how to set up the charger.

1

Insert the hearing aid into the charging inserts.

Make sure the left and right hearing aid markings match the left (blue)/right (red) indicators next to the charging inserts. The hearing aids will automatically switch off when inserted into the charger.

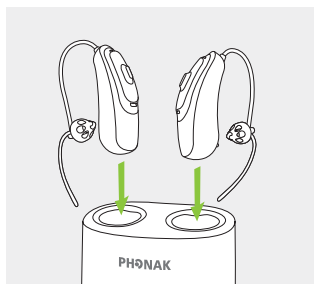
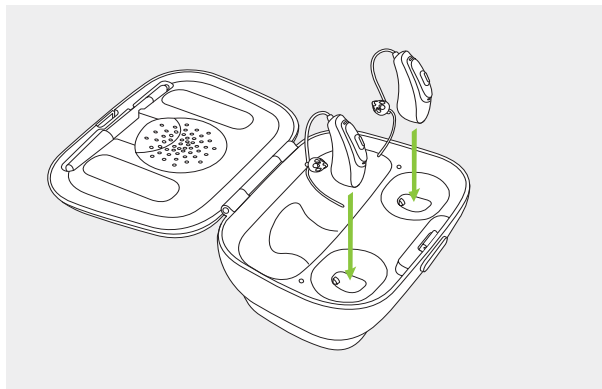

2

The indicator light will slowly blink until the hearing aid is fully charged. When fully charged the indicator light will remain on, i.e. solid green light.

The charging process will automatically stop when the batteries are fully charged, so the hearing aids can be safely left in the charger. It can take up to 3 hours to charge the hearing aids. The Charger Case RIC cover can be closed while charging.

i Naída B-R RIC charging times

100% charge: 3 h

50% charge: 60 min

80% charge: 90 min

30% charge: 30 min

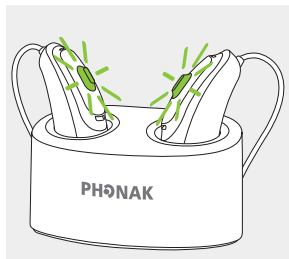
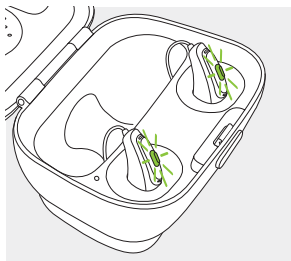

3

Remove the hearing aids from the charging inserts and switch them on, refer to chapter 7.

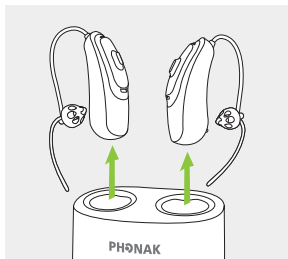
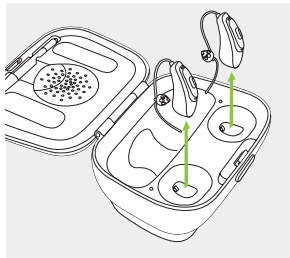

i Do not hold the tubes for removing the hearing aids from the charger as this can damage the tube.

4.2 Using the optional Power Pack

Note: The Power Pack is only compatible with the Charger Case RIC.

1

Attach the Power Pack to the Charger Case RIC and lock it.

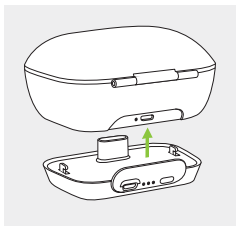

2

Plug in the micro-USB and connect to an external power supply. The Power Pack and hearing aids will be charged at the same time. While connected to an external power supply, the Power Pack indicator light will show the current battery charge status.

- i** Before using Power Pack for the first time, it is recommended to charge it for 3 hours.
- i** The Power Pack contains a built-in and non-removable rechargeable lithium-polymer battery.

micro-USB connection to external power source

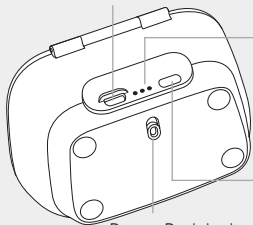

Indicator light battery status:

- 0%-29%
- 30%-59%
- 60%-100%

Battery check push button

Power Pack lock and release

3

The fully charged Power Pack offers 7 full charging cycles for a pair of hearing aids. To check the remaining battery capacity of the Power Pack, press the battery check push button (indicator lights will be off otherwise, to preserve battery).

i Please ensure to charge the Power Pack within operating temperature range: +5° to +40° Celsius (41° to 104° Fahrenheit)

5. Left & right hearing aid markings

There is a red or blue marking on the back of the hearing aid and on the speaker. This will tell you if it is a left or a right hearing aid.

Blue marking
for **left** hearing aid.

Red marking
for **right** hearing aid.

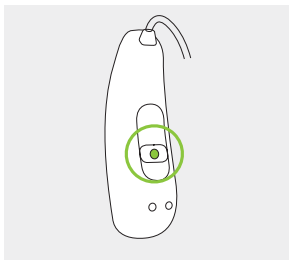

6. Push button

The push button has two functions:

Short push

The push button on your hearing aid can have various functions or is not active. This depends on the programming of the hearing aid, which is indicated in your individual "Hearing aid instructions". Please ask your hearing care professional for a printout.

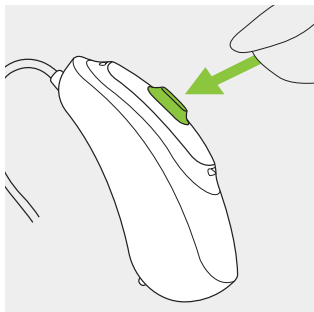

Long push (3 seconds)

The push button is used to switch the hearing aid on and off. Refer to next chapter.

7. On/Off

To switch the hearing aid on or off, firmly press the button using the tip of your finger for 3 seconds until the indicator light blinks.

One short blink =
hearing aid turns **on**

Two short blinks =
hearing aid turns **off**

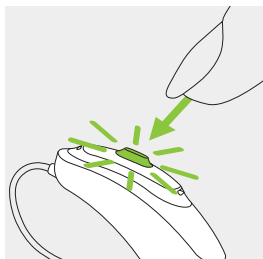

i When you switch on the hearing aid you may hear a start-up melody.

8. Putting on the hearing aid

1

Place the hearing aid behind your ear.



2

Insert the earpiece into your ear canal.

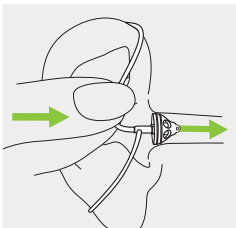

3

If there is an anchor attached to the earpiece, tuck it into the bowl of your ear to secure your hearing aid.

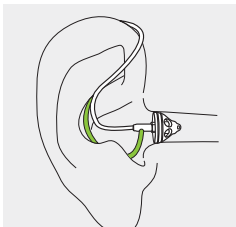

9. Removing the hearing aid

1

Pull on the bend of the tube and remove the hearing aid from behind the ear.

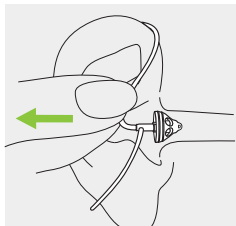

In very rare cases, your dome can remain in your ear canal when removing the hearing tube from the ear. In the unlikely case that the dome does get stuck in your ear canal, it is strongly recommended to see a physician for safe removal.

10. Operating conditions

The product is designed such that it functions without problems or restrictions if used as intended, unless otherwise noted in these user guides.

Please ensure to charge the hearing aid and Power Pack within operating temperature range: +5° to +40° Celsius (41° to 104° Fahrenheit) and atmospheric pressure range: 800 hPA to 1500 hPA.

Naída B-R RIC is classified IP68 (depth of 1 meter for 60 minutes) and designed to be used in all daily life situations. Therefore you do not have to worry about getting the hearing aids exposed to a rain shower or sweat. However, Naída B-R RIC is not intended to be used in water activities that includes chlorinated water, soap, salt water or other liquids with a chemical content.

Humidity during operation for the Charger Case RIC, Mini Charger RIC and Power Pack: 0% to 85% (non condensing).

11. Care and maintenance

Diligent and routine care of your hearing aid and chargers contribute to outstanding performance and a long service life.

Please use the following specifications as a guideline. Further information regarding product safety, see chapter 21.2.

General information

Before using hair spray or applying cosmetics, you should remove your hearing aid from your ear, because these products may damage it.

Your hearing aids are resistant to water, sweat and dust under the following conditions:

- After exposure to water, sweat or dust, the hearing aid is cleaned and dried.
- The hearing aid is used and maintained as described in this user guide.



Always make sure that the hearing aids and charger are dry and clean before charging.

Daily

Hearing aid: Inspect the earpiece for earwax and moisture deposits. Clean the surfaces with a lint-free cloth or use the small brush provided in the Charger Case RIC. Never use cleaning agents such as household detergents, soap, etc. for cleaning your hearing aid. It is not recommended to rinse with water. If you need to clean your hearing aid intensively, ask your hearing care professional for advice and information on filters or drying capsules.

Chargers: Make sure that charger inserts are clean. Never use cleaning agents such as household detergents, soap, etc. for cleaning your charger.

Weekly

Hearing aid: Clean the earpiece with a soft, damp cloth or with a special cleaning cloth for hearing aids. For more in-depth maintenance instructions or for more than basic cleaning, please see your hearing care professional. Clean the charging contacts on the hearing aid with a soft, damp cloth.

Chargers: Remove dust or dirt from the charger inserts.

12. Exchanging the earwax protection

Your hearing aid is equipped with an earwax protector to protect the speaker from earwax damage.

Please check the earwax protector regularly and exchange it if it looks dirty or if the hearing aid volume or sound quality is reduced. The earwax protector should be replaced every four to eight weeks.

12.1 Removing the earpiece from the speaker

1

Remove the earpiece from the speaker by holding the speaker in one hand and the earpiece in the other.

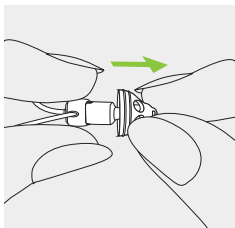

2

Gently pull on the earpiece to remove.

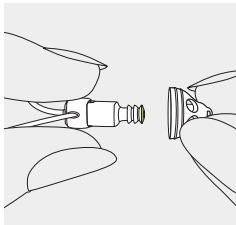

3

Clean the speaker with a lint-free cloth.

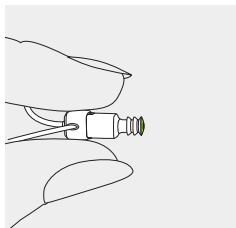

12.2 Exchanging the earwax protector

1

Insert the removal side of the exchange tool into the used earwax protector. The shaft of the holder should touch the rim of the earwax protector.

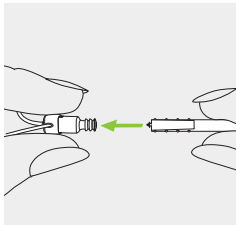

2

Carefully pull and remove the earwax protector straight out of the speaker. Please do not twist the earwax protector when removing.

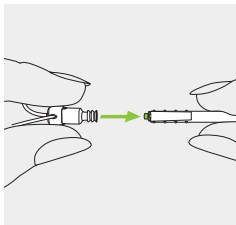

3

To insert the new earwax protector, gently push the insertion side of the exchange tool straight into the hole of the speaker until the outer ring is perfectly aligned.

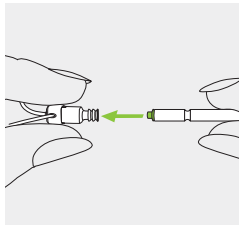

4

Pull the tool straight out. The new earwax protector will remain in place. Now attach your earpiece to the speaker.

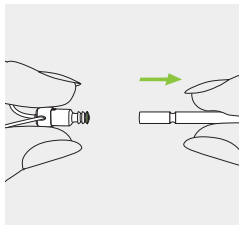

12.3 Attaching the earpiece to the speaker

1

Hold the speaker in one hand and the earpiece in the other.

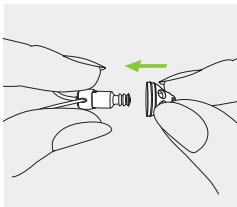

2

Slide the earpiece over the speaker sound outlet.

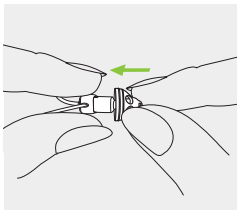

3

The speaker and the earpiece should fit perfectly together.

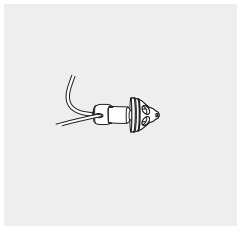

13. Roger for conversation in noise and over distance

Are you often in situations where the noise level is high or the distance to the speaker/talker is more than 1.5 m (5 feet)? For instance in

- noisy restaurants, cafés and bars
- family gatherings
- business meetings, presentations and lectures featuring one or more speakers
- one-to-one conversations
- cell phone calls
- watching TV and listening to music
- in the car
- online video calls

Combining your Phonak Naída B-R RIC hearing aids with a Roger wireless microphone enables you to hear and understand more speech in these challenging situations.
www.phonak.com/roger

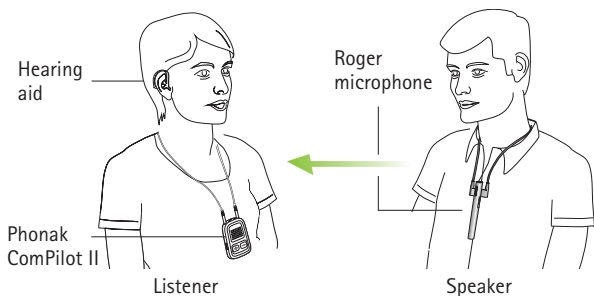

The Roger microphone transmits the speaker's voice into your ears. The system consists of three main elements: Your Naída B-R RIC hearing aids, the ComPilot II with attached Roger X receiver, and the Roger microphone.

Ask your hearing care professional for a Roger demo and more information.

14. Wireless accessories

A range of Phonak wireless accessories are available for you to use with your hearing aid.

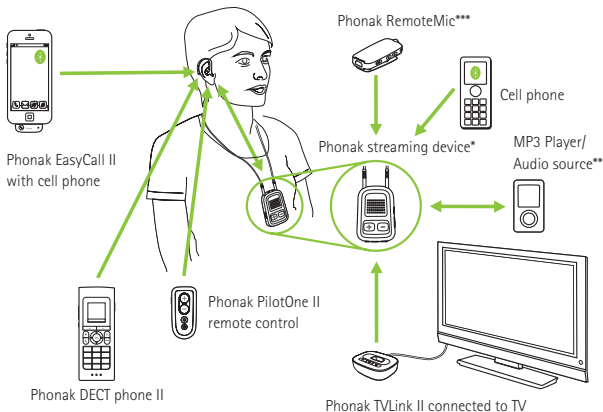

* The Phonak ComPilot II with neckloop or ComPilot Air II with clip to attach to clothing. They also have basic remote control functionalities. For advanced control they can be used with the Phonak RemoteControl App.

** Audio sources (e.g. MP3 Player, computer, laptop, tablet) can be connected to the streaming device via Bluetooth or audio cable.

*** Clipped onto the speaker's clothing for better understanding over distance in quiet situations.

15. Join our hearing loss community!

On HearingLikeMe.com you will find:

- **Living with Hearing Loss**

A set of interesting articles on how to live with hearing loss.

- **Forum**

A forum to meet and engage with a growing number of people who face the same challenges.

- **Blog**

A blog to keep up to date with the latest news on anything hearing.

HearingLikeMe
.com

16. A solution beyond your hearing aid

As your hearing loss progresses, a hearing aid may no longer be the right solution for you. If you struggle to understand speech or talk on the phone, it may be time to consider an Advanced Bionics (AB) cochlear implant for the next step in your journey to hearing. With today's advancements in hearing technology, an increasing number of people with significant hearing loss are enjoying restored hearing with cochlear implants. This advanced hearing solution is designed to help you regain the sounds and joys of life you may be missing because of your hearing loss.

A cochlear implant system consists of two main components. The external component is a sound processor that is worn on the outer ear like a hearing aid or discreetly on the body. The internal component is the implant, which delivers sound to the hearing nerve. Unlike hearing aids, cochlear implants bypass the damaged part of an ear and send electrical signals directly to the brain via the auditory nerve. Hearing with cochlear implants can help you hear the sounds

that truly enrich life — the sweet songs of nature, shared laughter among friends, the many dimensions of music, and much more.

AB and Phonak are sister companies that work together to help people with significant hearing loss. The Naída CI sound processor from Advanced Bionics provides unique, groundbreaking features that help recipients hear better in any environment. As a result of the unique relationship that AB and Phonak share, the Naída CI sound processor offers some of the features available with your Naída hearing aids. These features include technology designed for improved speech understanding and listening comfort in a variety of situations. If you have a Roger system for better understanding in noise and over distance, for enjoying music and TV and cell phone usage, you can continue to use that with your Advanced Bionics cochlear implant.

For more information on Naída CI and AB cochlear implant technology, please visit **AdvancedBionics.com**



17. Service and warranty

Local warranty

Please ask the hearing care professional where you purchased your hearing aids and chargers about the terms of the local warranty.

International warranty

Sonova AG offers a one year limited international warranty, valid from the date of purchase. This limited warranty covers manufacturing and material defects in the hearing aid and chargers respectively, but not accessories such as tubes, earpieces, external receivers. The warranty only comes into force if a proof of purchase is shown.

The international warranty does not affect any legal rights that you might have under applicable national legislation governing sale of consumer goods.

Warranty limitation

This warranty does not cover damage from improper handling or care, exposure to chemicals or undue stress. Damage caused by third parties or non-authorized service centers renders the warranty null and void. This warranty does not include any services performed by a hearing care professional in their office.

Serial numbers

Hearing aid left side: _____

Hearing aid right side: _____

Charger Case RIC: _____

Power Pack: _____

Mini Charger RIC: _____

Date of purchase: _____

Authorized hearing care
professional (stamp/signature):

18. Compliance information

Europe:

Declaration of Conformity for the hearing aid

Hereby Sonova AG declares that this product meets the requirements of the Medical Devices Directive 93/42/EEC as well as the Radio Equipment Directive 2014/53/EU. The full text of the EU Declaration of Conformity can be obtained from the manufacturer or the local Phonak representative whose address can be taken from the list on www.phonak.com (Phonak worldwide locations).

Australia/New Zealand:



R-NZ

Indicates a device's compliance with applicable Radio Spectrum Management's (RSM) and Australian Communications and Media Authority (ACMA) regulatory arrangements for the legal sale in New Zealand and Australia.

The compliance label R-NZ is for radio products supplied in the New Zealand market under conformity level A1.

The wireless models listed on page 2 are certified under:

Phonak Naída B-R RIC (B90/B70/B50)

USA **FCC ID:** KWC-RICR

Canada **IC:** 2262-RICR

Notice 1:

This device complies with Part 15 of the FCC Rules and with RSS-210 of Industry Canada. Operation is subject to the following two conditions:

- 1) this device may not cause harmful interference, and
- 2) this device must accept any interference received, including interference that may cause undesired operation.

Notice 2:

Changes or modifications made to this device not expressly approved by Sonova AG may void the FCC authorization to operate this device.

Notice 3:

This device has been tested and found to comply with the limits for a Class B digital device, pursuant to Part 15 of the FCC Rules and ICES-003 of Industry Canada. These limits are designed to provide reasonable protection against harmful interference in a residential installation. This device generates, uses and can radiate radio frequency energy and, if not installed and used in accordance with the instructions, may cause harmful interference to radio communications. However, there is

no guarantee that interference will not occur in a particular installation. If this device does cause harmful interference to radio or television reception, which can be determined by turning the equipment off and on, the user is encouraged to try to correct the interference by one or more of the following measures:

- Reorient or relocate the receiving antenna.
- Increase the separation between the device and receiver.
- Connect the device into an outlet on a circuit different from that to which the receiver is connected.
- Consult the dealer or an experienced radio/TV technician for help.

Radio information of your wireless hearing aid

Antenna type	Integrated ferrite coil antenna (inductive)
Operation frequency	10.6 MHz
Occupied bandwidth (99% BW)	approx. 500 kHz
Modulation	DQPSK
Channel	Single channel radio
Operating range	18 cm (7")
Use case	Streaming of audio signal to receiving hearing aid on the other ear
Magnetic field strength @ 1m	-4 dB μ A/m

19. Information and description of symbols



With the CE symbol, Sonova AG confirms that this product – including accessories – meets the requirements of the Medical Devices Directive 93/42/EEC as well as the Radio Equipment Directive 2014/53/EU. The numbers after the CE symbol correspond to the code of certified institutions that were consulted under the above-mentioned directives.



This symbol indicates that the products described in these user instructions adhere to the requirements for an applied part of Type B of EN 60601-1. The surface of the hearing aid is specified as an applied part of Type B.



Indicates the medical device manufacturer, as defined in EU Directive 93/42/EEC.



This symbol indicates that it is important for the user to read and take into account the relevant information in these user guides.



This symbol indicates that it is important for the user to pay attention to the relevant warning notices in these user guides.



Important information for handling and product safety.



This symbol confers that the electromagnetic interference from the device is under limits approved by the US Federal Communications Commission.



Indicates the manufacturer's serial number so that a specific medical device can be identified.



Indicates the manufacturer's catalogue number so that the medical device can be identified.



This symbol indicates that it is important for the user to read and take into account the relevant information in this user guide.



Temperature during transportation and storage: -20° to $+60^{\circ}$ Celsius (-4° to $+140^{\circ}$ Fahrenheit).



Humidity during storage: 0% to 70%, if not in use. See instruction in chapter 21.2 regarding drying the hearing aid after use.



Atmospheric pressure during transportation and storage: 200 hPa to 1500 hPa



During transportation keep dry.



The symbol with the crossed-out garbage bin is to make you aware that this hearing aid as well as chargers and Power Pack may not be thrown away as normal household waste. Please dispose of old or unused hearing aids and charger, at waste disposal sites intended for electronic waste, or give your hearing aid and charger to your hearing care professional for disposal. Proper disposal protects the environment and health.

20. Troubleshooting

20.1 Troubleshooting hearing aid

Problem	Causes
Hearing aid not functioning	Blocked speaker/earpiece
	Hearing aid switched off
	Electromagnetic disturbances occurred
	Battery fully discharged
Hearing aid whistles	Hearing aid not inserted correctly into ear
	Cerumen in ear canal
Hearing aid not loud enough or distorted	Volume too loud
	Low battery
	Speaker/earpiece blocked
	Volume too low
	Hearing has changed
Hearing aid plays two beeps	Indication for low battery
Hearing aid will not start up	Battery fully discharged
Indicator light on hearing aid blinks fast while charging	Faulty battery

What to do

Clean speaker opening/earpiece

Press push button for 3 seconds (chapter 1+7)

Press push button

Insert hearing aid into the charger

Charge hearing aid (chapter 4)

Insert hearing aid correctly (chapter 8)

Contact your ENT/GP or hearing care professional

Decrease volume if volume control available (chapter 6)

Charge hearing aid (chapter 4)

Clean speaker opening/earpiece

Turn volume up if volume control available (chapter 6)

Contact your hearing care professional

Charge hearing aid (chapter 4)

Charge hearing aid (chapter 4)

Contact your hearing care professional if the battery life is not as expected

Problem

Indicator light on the hearing aid is off when placed in the charging inserts

Battery does not last the whole day

Causes

Hearing aid not inserted correctly into charger

Charger not connected to power source

Hearing aid not fully charged

Battery may need to be replaced

20.2 Troubleshooting charger

Problem

Indicator light on the hearing aid does double flash

Charging does not start (no power pack used)

Charging does not start when using Power Pack

Causes

Hearing aid out of its operating temperature range

Charger Case RIC or

Mini Charger RIC not connected to power supply

Hearing aid not inserted correctly into charger

Power Pack discharged



If the problem persists, contact your hearing care professional for assistance.

What to do

Insert hearing aid correctly into charger (chapter 4)

Connect charger to external power supply

Charge hearing aid (chapter 4)

Contact your hearing care professional; a battery replacement may be required

What to do

Warm the hearing aid up. The operating temperature range is +5° to +40° Celsius (41° to 104° Fahrenheit)

Connect charger to power supply or Power Pack (chapter 4.2)

Insert hearing aid correctly into charger (chapter 4.1)

Charge Power Pack (chapter 4.2)

21. Important safety information

Please read the information on the following pages before using your hearing aid and charging accessories.

A hearing aid will not restore normal hearing and will not prevent or improve a hearing impairment resulting from organic conditions. Infrequent use of a hearing aid does not permit a user to attain full benefit from it. The use of a hearing aid is only part of hearing habilitation and may need to be supplemented by auditory training and instruction in lipreading.

The hearing aid is suitable for the home healthcare environment and due to their portability it may happen that it is used in professional healthcare facility environment like physician offices, dental offices etc.

21.1 Hazard warnings

 The Phonak rechargeable hearing aids and the Phonak Power Pack contain lithium-ion batteries that can be taken onto airplanes as carry-on luggage. The Power Pack cannot be placed in the checked-in baggage and can only be placed in the carry-on luggage.

 The intended use of hearing aids is to amplify and transmit sound to the ears and hereby compensate for impaired hearing. The hearing aids (specially programmed for each hearing loss) must only be used by the intended person. They should not be used by any

other person as they could damage hearing.

 Changes or modifications to the hearing aid that were not explicitly approved by Sonova AG are not permitted. Such changes may damage your ear or the hearing aid.

 Do not use the hearing aids and charging accessories in explosive areas (mines or industrial areas with danger of explosions, oxygen rich environments or areas where flammable anesthetics are handled) or where electronic equipment is prohibited.

 If you feel pain in or behind your ear, if it is inflamed or if skin irritation and accelerated accumulations of earwax occur, please check with your hearing care professional or physician.

 In very rare cases, the dome can remain in your ear canal when removing the hearing tube from the ear. In the unlikely case that the dome does get stuck in your ear canal, it is strongly recommended to see a physician for safe removal.

 Hearing programs in the directional microphone mode reduce background noises. Please be aware that warning signals or

noises coming from behind, e. g. cars, are partially or entirely suppressed.

 This hearing aid is not for children below 36 months. It contains small parts that can cause choking, if swallowed by children. Keep out of reach of children, individuals with cognitive impairment and pets. If swallowed, consult a physician or hospital immediately.

 Keep the Charger Case RIC out of reach of children, individuals with cognitive impairment and pets. If the drying capsule is swallowed, consult a physician or hospital immediately.

 Only authorized personnel are allowed to open the Power Pack due to possible electrical hazard.

 Do not make a wire connection from your hearing aid to any external audio sources like radio etc. That could cause injuries on your body (electric shock).

 Do not cover the whole Charger Case RIC or Mini Charger RIC while charging, e.g. with a cloth etc.

 The following is only applicable for persons with active implantable medical devices (i.e. pacemakers, defibrillators, etc.):

- Keep the wireless hearing aid at least 15 cm (6 inches) away from the active implant. If you experience any interference, do not use the wireless hearing aids and contact the manufacturer of the active implant. Please, note that interference can also be caused by power lines, electrostatic discharge, airport metal detectors etc.
- Keep magnets (i.e. EasyPhone magnet, etc.) at least 15 cm (6 inches) away from the active implant.
- If using a Phonak wireless accessory, consult the chapter "Important safety information" in your wireless accessory user guide.

 Use of this equipment adjacent to or stacked with other equipment should be avoided because it could result in improper operation. If such use is necessary, this equipment and the other equipment should be observed to verify that they are operating normally.

 Use of accessories, transducers and cables other than those specified or provided by the manufacturer of this equipment could result in increased electromagnetic emissions or decreased electromagnetic immunity of this equipment and result in improper operation.

 Portable RF communications equipment (including peripherals such as antenna cables and external antennas) should be used no closer than 30 cm (12 inches) to any part of the Naída B-R RIC, including cables specified by the manufacturer. Otherwise, degradation of the performance of this equipment could result.

 The USB port of the charger is to be used for the described purpose only.

 For charger, use only EN60950 and/or EN60601-1 certified equipment with a output rating of 5 VDC. Min. 500 mA.

 Do not insert the adapter of the power supply alone into electrical outlets because this could result in an electric shock.

 Hearing aids should not be fitted with domes / wax protection systems when used by clients with perforated eardrums, inflamed ear canals or otherwise exposed middle ear cavities. In these cases, we recommend the use of a custom earpiece. In the unlikely case that any part of this product should remain in the ear canal, it is strongly recommended to see a physician for safe removal.

21.2 Information on product safety

- ① Phonak hearing aids are water resistant and not waterproof. They are designed to withstand normal activities and occasional accidental exposure to extreme conditions. Never immerse your hearing aid in water! Phonak hearing aids are not specifically designed for extended periods of water submersion on a continual basis, that is worn in activities such as swimming or bathing. Always remove your hearing aid before these activities, as the hearing aid contains sensitive electronic parts.
- ① Protect your hearing aid from heat (never leave near a window or in the car). Never use a microwave or other heating devices to dry your hearing aid (due to risk of fire or explosion). Ask your hearing care professional about suitable drying methods.
- ① The dome should be changed every three months or when it becomes stiff or brittle. This is to prevent the dome from detaching from the tube spout during insertion into or removal from the ear.

❗ Do not drop your hearing aid! Dropping onto a hard surface can damage your hearing aid.

❗ Store your hearing aid in the charger if you are not using it for a long period of time.

❗ Special medical or dental examination including radiation described below, may adversely affect the correct functioning of your hearing aids. Remove and keep them outside the examination room/area before undergoing:

- Medical or dental examination with X-ray (also CT scan).
- Medical examinations with MRI/NMRI scans, generating magnetic fields.

Hearing aids don't need to be removed when passing security gates (airports etc.). If X-ray is used at all, it will be in very low doses, and will not affect the hearing aids.

- ① The hearing aids have to be dry before charging. Otherwise the charging reliability cannot be guaranteed.
- ① Only use approved chargers and Power Pack described in this user guide for charging Naída B-R RIC, otherwise the devices may be damaged.
- ① Both your hearing aid(s) and Power Pack contain lithium-ion batteries with a Watt hour rating <20 Wh which have been tested according to UN 38.3 of the "UN Manual of Tests and Criteria" and should be shipped in accordance with all the rules and regulations on the safe shipment of lithium-ion batteries.

Notes

Your hearing care professional:



Manufacturer:

Sonova AG

Laubisrütistrasse 28

CH-8712 Stäfa

Switzerland

www.phonak.com



029-0573-03N1.01/2018-02/© 2018 Sonova AG All rights reserved

sonova
HEAR THE WORLD

